

5TH/REVERSE GEAR AND HOUSING PARTS DISASSEMBLY

B3E051501029M03

1. Disassemble in the order indicated in the table.

Caution

- If any old sealant gets into the transaxle during installation of the transaxle case, trouble may occur in the transaxle. Remove any old sealant from the transaxle case and clutch housing, and with cleaning fluids.

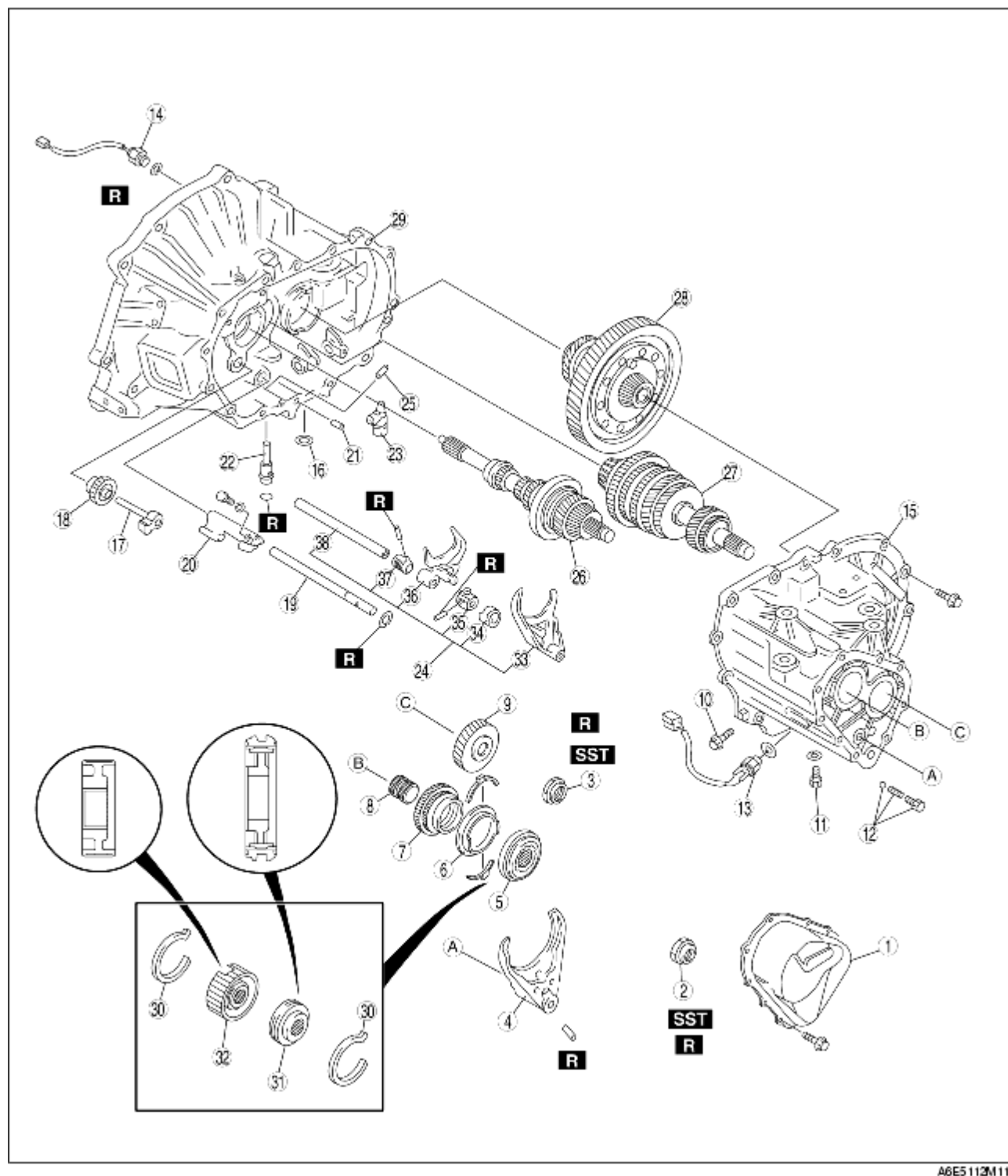

A6E5113M117

1	Rear cover
2	Locknut (primary shaft) (See Locknut Disassembly Note.)
3	Locknut (secondary shaft) (See Locknut Disassembly Note.)
4	5th/reverse shift fork
5	5th/reverse clutch hub component
6	5th synchronizer ring
7	5th gear
8	Gear sleeve

9	Secondary 5th gear
10	Lock bolt
11	Guide bolt
12	Lock bolt, ball, and spring
13	Back-up light switch
14	Neutral switch
15	Transaxle case component
16	Magnet
17	Reverse idler shaft
18	Reverse idler gear
19	5th/reverse shift rod
20	5th/reverse shift rod end
21	Pin
22	Crank lever shaft
23	Crank lever component
24	Shift fork and shift rod component (See Shift Fork and Shift Rod Component Disassembly Note.)
25	Push pin
26	Primary shaft gear component
27	Secondary shaft gear component
28	Differential component
29	Clutch housing
30	Synchronizer key spring
31	Clutch hub sleeve
32	Clutch hub
33	3rd/4th shift fork
34	Interlock sleeve
35	Control lever
36	1st/2nd shift fork
37	Control end
38	Control rod

Locknut Disassembly Note

1. Assemble the **SST**.

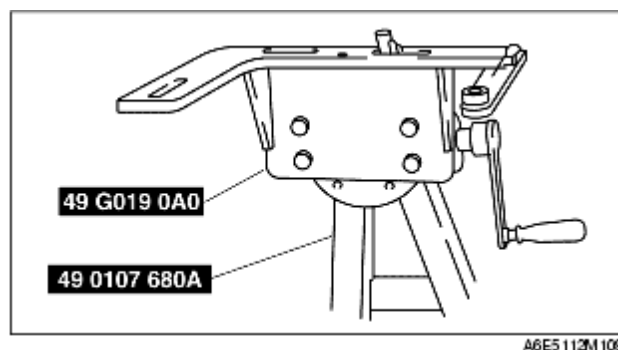

2. Lift the transaxle and mount it on the **SST**.

3. Lock the primary shaft with the **SST**.

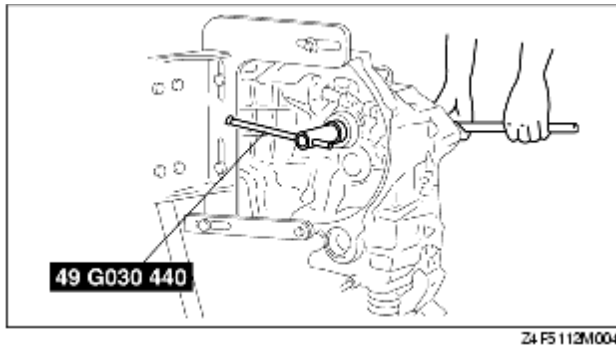

4. Shift to 1st gear to lock the rotation of the primary shaft.
5. Bend back the caulking of locknuts using a chisel.
6. Remove the locknuts from the primary and secondary shafts.

Shift Fork and Shift Rod Component Disassembly Note

1. Align the ends of the interlock sleeve and of the control lever (arrow). Turn the shift rod counterclockwise.

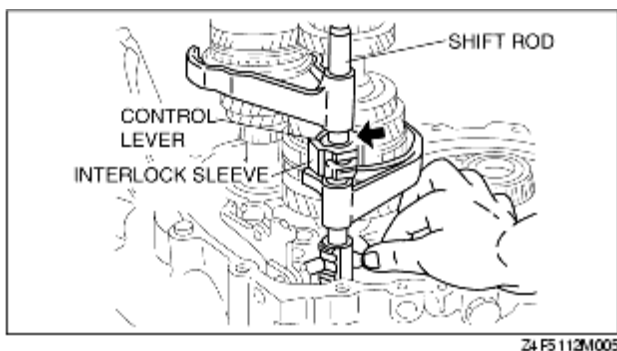

2. While holding the 1st/2nd shift fork with one hand and the 3rd/4th shift fork with the other, raise them both at the same time and shift each of the clutch hub sleeves.
3. Lift the control end and remove the steel, and at the same time, remove the control rod from the clutch housing.

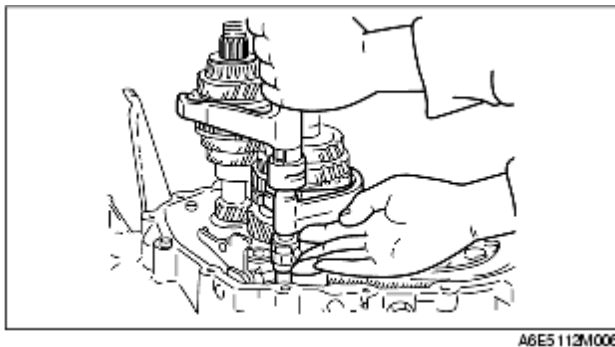

4. Separate the shift rod and shift fork component from each of the clutch hub sleeves.